

Jerusalem Congress Venue

The ICC Convention Center



Situated at the gateway of Jerusalem, The ICC Jerusalem International Convention Center (ICC) is overlooking the city's panoramic landscape. This impressive venue is Israel's largest convention center and has hosted many presidential receptions, international exhibitions by distinguished artists, important industry-related conventions and spectacular performances. Throughout the years, ICC has demonstrated professionalism and reliability. The venue's reputation has been augmented by its professional staff, as well as, its efficient logistical support and capabilities.

The Venue

The mega ICC complex, with its 27 custom-designed halls provides a tailored solution for any kind of event including conferences, congresses, trade fairs, seminars, symposia, social encounters, business events, and private events. The huge space and scores of halls can be divided according to every and each client requirements offering great flexibility for hosting 100 up to 20,000 participants. The venue's abundance of entrances and exits facilitate the concurrent occurrence of a single large-scale event, alongside subdivision of smaller groups. There are 12,000 square meters (130,000 square feet) of exhibition space and halls spread over ten different spaces on two levels. Large parking lots are adjacent to the Center, including covered parking.

ICC Services

- ❖ Easy and comfortable accessibility
- ❖ 850 parking places adjacent to the center
- ❖ Comfortable Access for the disabled
- ❖ Prestigious catering services
- ❖ Communications availability
- ❖ Hostesses, ushers and security services
- ❖ Stage and design services
- ❖ Simultaneous translation

ICC Jerusalem is a member of the AIPC and ICCA, and conforms to their international standards.

Accessibility

ICC is easy to get to with access to both city and intercity public transportation. The venue has several international chain hotels within walking distance such as the Holiday Inn & Crown Plaza, both adjacent to the Center. Catering service and lunches are offered through the ICC, with many alternative of nearby local restaurants to facilitate all budgets or simply add a unique variety.

Distance for International Airport to Jerusalem ICC 51.3 km, 37 minutes

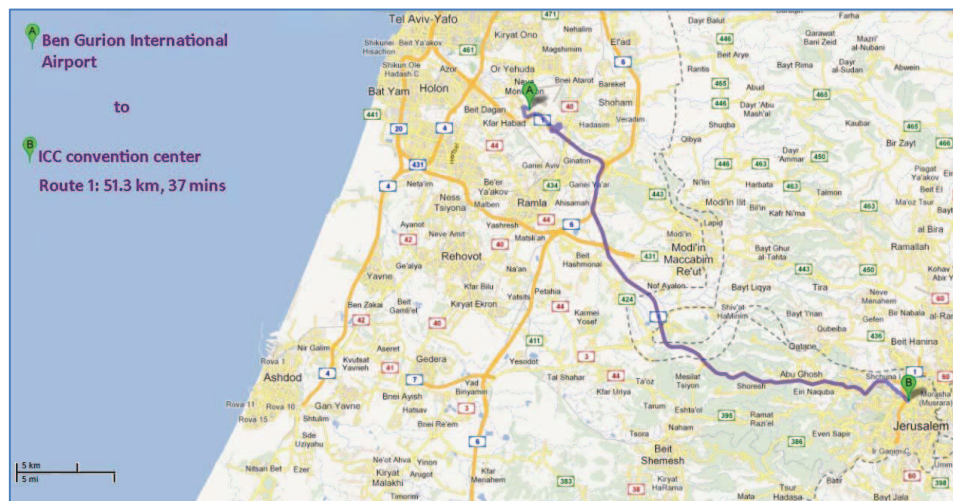

ICC Jerusalem Convention Center & Crowne Plaza halls												
October 7 - 16, 2015												
Room	Description	WED	THU	FRI	SAT	SUN	MON	TUE	WED	THU	FRI	Theater
		07-Oct	08-Oct	09-Oct	10-Oct	11-Oct	12-Oct	13-Oct	14-Oct	15-Oct	16-Oct	
ICC - Ussishkin 3,000 seats and Big Dulzin hall in closed circuit TV (500 seats)	Opening Ceremony - 1RM 3,500 seats						→					AUDITORIUM 3,000 seats + Big Dulzin hall 500 seats
ICC - Ussishkin 3,000 seats	Welcome Reception - 1RM 3,500 seats (Monday evening)						→					AUDITORIUM 3,000 seats
ICC - Teddy A 400 seats around table	IISL Annual Dinner: 200-300 around tables seats								→			400 Seats around tables
ICC - Ussishkin	Moot Court Competition (3 hours afternoon)								→			AUDITORIUM
ICC - Ussishkin 3,000 seats	Plenary and Highlight Lecture Sessions - 1 room 1,000 seats						→					AUDITORIUM 3,000 seats
ICC - Small Dulzin 250 seats	Technical Sessions 1 of 18: 1 room for 250 seats						→					Theater Style 250 seats
ICC - 313: 150 seats	Technical Sessions 2 of 18: room for 120 seats						→					Theater Style 150 seats
ICC - Oren 1: 130 seats	Technical Sessions 3 of 18: room for 120 seats						→					Theater Style 130 seats
ICC - Oren 2: 160 seats	Technical Sessions 4 of 18: room for 120 seats						→					Theater Style 160 seats
ICC - Oren 3: 230 seats	Technical Sessions 5 of 18: room for 120 seats						→					Theater Style 230 seats
ICC - Oren 4: 230 seats	Technical Sessions 6 of 18: room for 120 seats						→					Theater Style 230 seats
ICC - Schwartz Hall 289 seats	Technical Sessions 3 of 18: room for 120 seats						→					AUDITORIUM 289 seats
ICC - Eshkol 1: 119 seats	Technical Sessions 7 of 18: room for 120 seats						→					AUDITORIUM 119 seats
ICC - Eshkol 2: 225 seats	Technical Sessions 8 of 18: room for 120 seats						→					AUDITORIUM 225 seats
ICC - Eshkol 3: 127 seats	Technical Sessions 9 of 18: room for 120 seats						→					AUDITORIUM 127 seats
ICC - Teddy B: 300 seats	Technical Sessions 10 of 18: room for 120 seats						→					Theater Style 300 seats
ICC - Teddy C: 300 seats	Technical Sessions 11 of 18: room for 120 seats						→					Theater Style 300 seats
ICC - 314: 50 seats	Technical Sessions 13 of 18: 80 Seats each						→					Theater Style 50 seats
Crowne Plaza - Ein Gedi & Arad Halls: 100 seats	Technical Sessions 14 of 18: 80 Seats each						→					Theater Style 100 seats
Crowne Plaza - Masada & Jericho Halls: 100 seats	Technical Sessions 15 of 18: 80 Seats each						→					Theater Style 100 seats
Crowne Plaza - Ballroom A: 300 seats	Technical Sessions 16 of 18: 80 Seats each						→					Theater Style 300 seats
Crowne Plaza - Ballroom B: 350 seats	Technical Sessions 17 of 18: 80 Seats each						→					Theater Style 350 seats
Crowne Plaza - Kerem & Carmit Halls: 150 seats	Technical Sessions 18 of 18: 80 Seats each						→					Theater Style 150 seats
ICC - Big Dulzin: 500 seats	Special purpose room: 1 room for 300 pers. (used for the UN/IAF Workshop, IAF General Assembly, IPC General Meeting, Academy Day Plenary and special sessions: The International Meeting of Members of Parliament and the IAC cities summit) in proximity to the session rooms		→				→					Theater Style 500 seats

Room	Description	WED	THU	FRI	SAT	SUN	MON	TUE	WED	THU	FRI	Theater
		07-Oct	08-Oct	09-Oct	10-Oct	11-Oct	12-Oct	13-Oct	14-Oct	15-Oct	16-Oct	
ICC Hadarim Patio 3: 80 seats	Press Center (can accommodate 20 journalists +4 computers tables, chairs, telephones)			→		→	→	→	→	→	→	80 seats class room style
ICC 305: 15 seats	Speakers Preparation Room (5 computers +internet access)			→		→	→	→	→	→	→	15 seats class room style
ICC Foyer Oranim	IAF Members Lounge (table and chair for 30 persons + 3 desktop computers + coffee, tea, soft drinks, water and cookies)					→	→	→	→	→	→	N/A
Crowne Plaza Dining room: 100 seats around table	VIP Private Dining area luncheons						→	→	→	→	→	100 seats around tables
ICC Glass Hall: 200 people	Registration Desk Area: 6 registration counters, 1 press registration counter, 2 congress bags collection counter			→		→	→	→	→			350
ICC Entrance Hall, Pinkus Hall + Agam Foyer & Exhibition Hall	internet café (adjacent to the exhibition area+ 15 high speed cable internet connection, several wireless access point + 10 computers		→	→		→	→	→	→	→	→	3200
	Exhibition & Posters						→	→	→	→	→	
	Student Exhibition Area and Cluster Forum:200-500 sqm in the IAC Exhibition area						→	→	→	→	→	
	Food Court: Luncheons, snacks and refreshments area at extra charge for participants		→	→		→	→	→	→	→	→	
	Accompanying persons area: casual seating for 10 persons		→	→		→	→	→	→	→	→	
ICC - Teddy A+B+C Halls 700 seats around table	Gala Dinner: 500 participants									→		700 seats around tables
ICC - Teddy A 400 seats around table	Student and Young Professionals Programmes Session Rooms: 200 seat & an area for 250 Young Professionals for cocktail receptions			→		→	→	→	→	→	→	Theater Style 900 seats and 400 seats around tables
Crowne Plaza Meeting room: 12 seats around table	Spare rooms for meetings		→	→		→	→	→	→	→	→	12 seats around table

The International Convention Centre

ICC Halls Layout

Spacious and Flexible

ICC has the ability and the option to customize each Hall according to the client's requirements and preferences. Rooms and Halls can be sectioned or expanded as necessary. ICC space can contain up to 10,000 people comfortably throughout the main Hall, seminar rooms, exhibition areas and various rest sections.



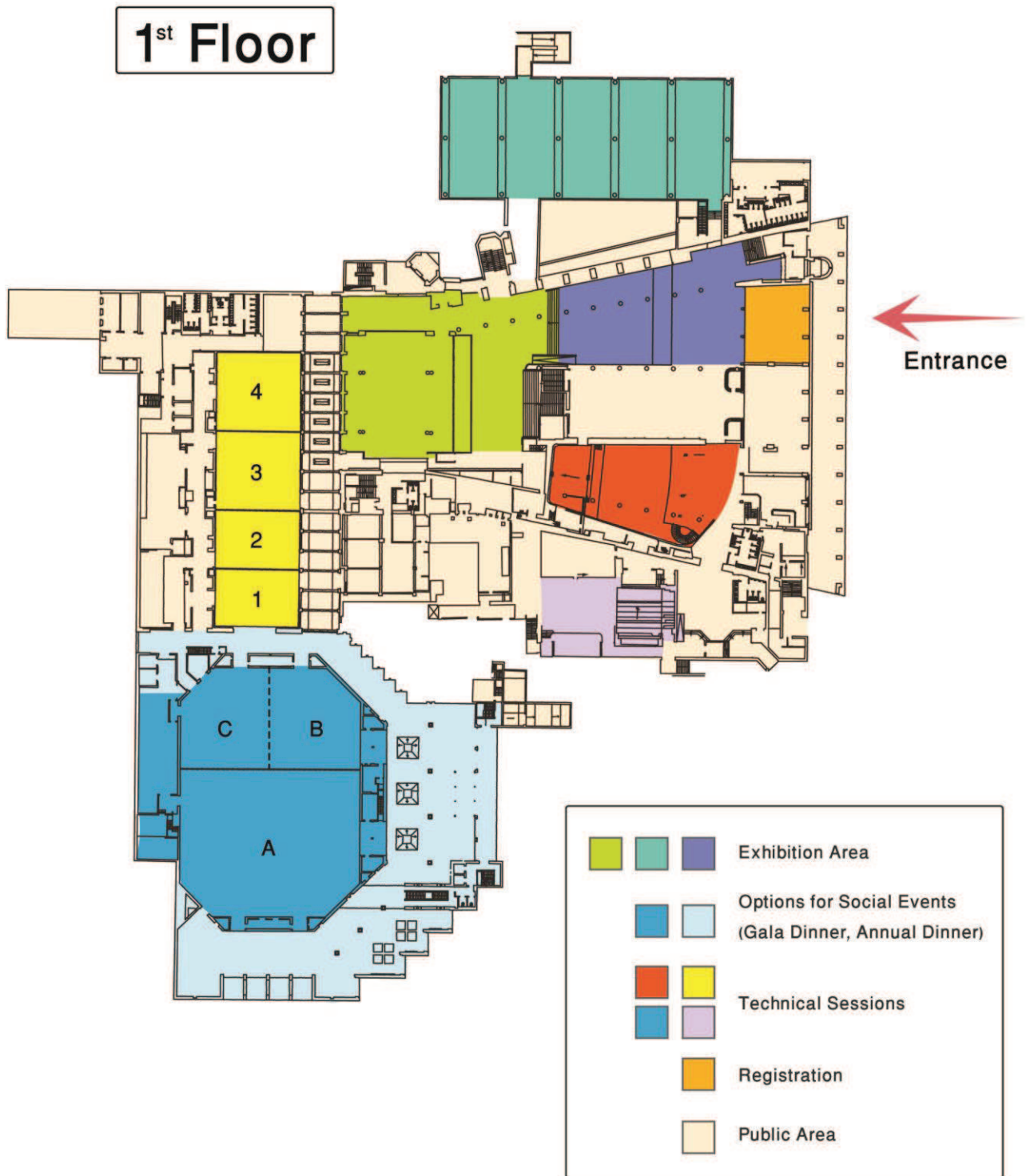

2nd Floor

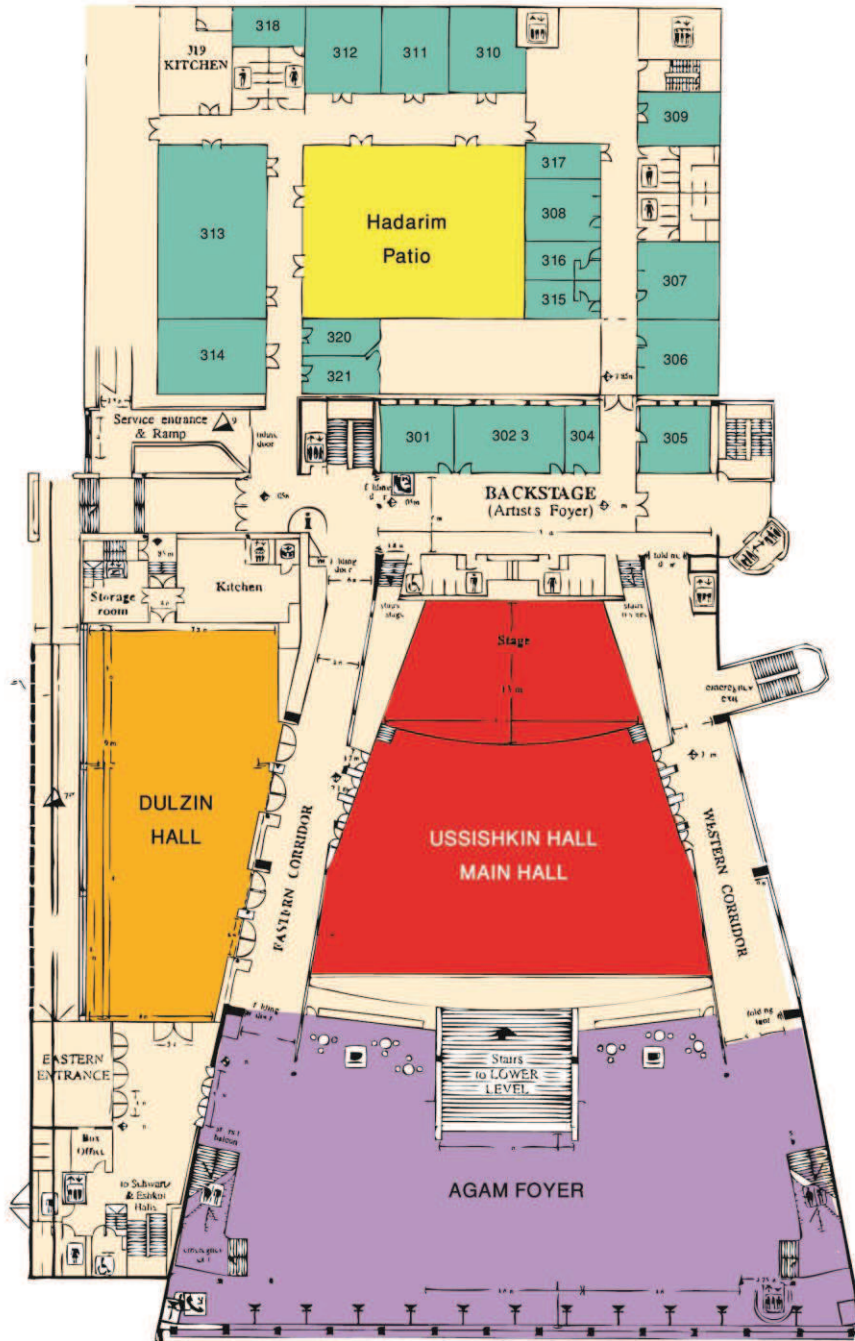

- Opening Ceremony
Welcom Reception
Moot Court Competition
Plenary
- Exhibition Area
- Technical Sessions
Special Purpose Room
- Press Center
- IAF Secretariat Office
IAF Executive
Speakers Preparation
IAA Secretariat Office
IPC Co-Chairs Office
- Public Area

Crowne Plaza Halls Layout

Technical Sessions and Committee Meeting will be held at Crowne Plaza Halls.

1st Floor

Technical Sessions and Committee Meeting Rooms

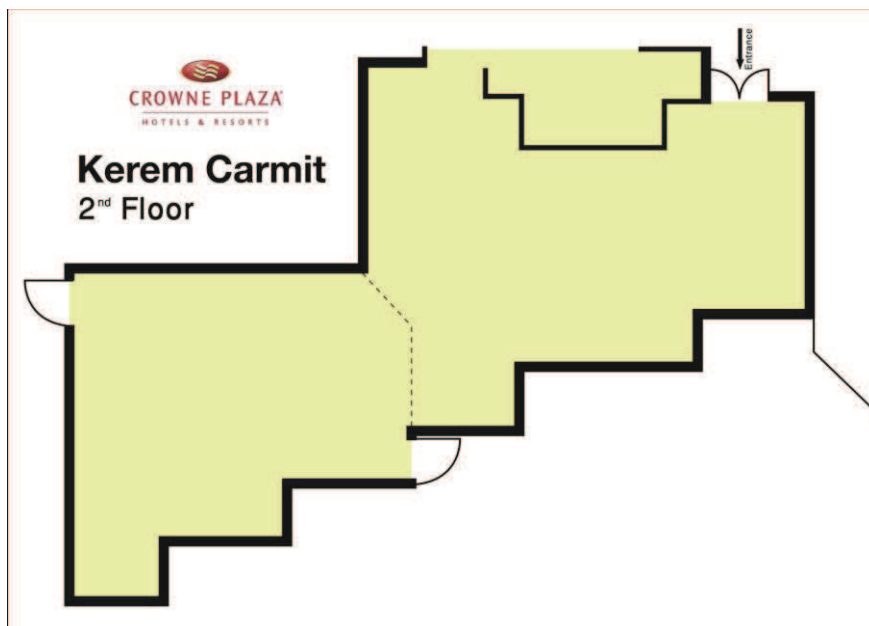
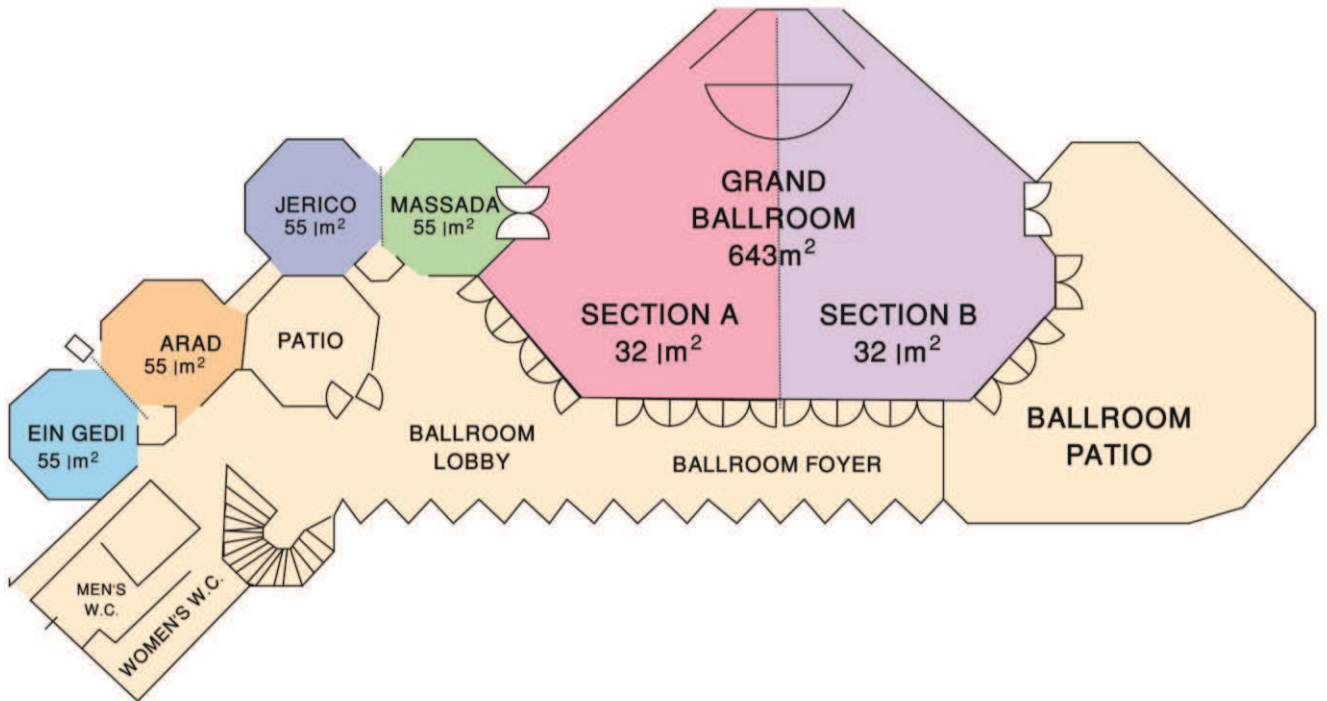

ICC Meeting Halls

Teddy Hall (A,B,C,D in 1st Floor Diagram)

Building and Occupancy

The spacious Teddy Hall can host 1,000 people seated at round tables, and 2,000 people in receptions, conferences and buffet-style meals. It has an immense flexibility and can be divided by acoustic partitions into four separate halls of varying sizes and capacities, in accordance with the events requirements. The open areas and entrance foyer, surrounding the hall on three sides, are designed for registration, receptions and exhibitions, as well as rest and meeting areas between conference sessions. These areas can hold up to 1,000 people. **Teddy halls are suitable for IISL Annual Dinner, IAC Gala Dinner, Young Professional Programmes Sessions and Student Cocktail Reception.**

Teddy A Hall: 842 square meters
Maximum Occupancy: 900 people

Teddy B Hall: 290 square meters
Maximum Occupancy: 300 people

Teddy C Hall: 308 square meters
Maximum Occupancy: 300 people

Teddy D Hall: 104 square meters
Maximum Occupancy: 80 people

Special Equipment and Accessories

an underground parking space for up to 330 vehicles, an adjacent kitchen, audio-visual systems, projection equipment, 8 translation cubicles facing the conference participants. Electricity and telephone outlets installed in the floors and walls, ceiling with a unique built-in decorative rods designed for connecting lighting equipment.

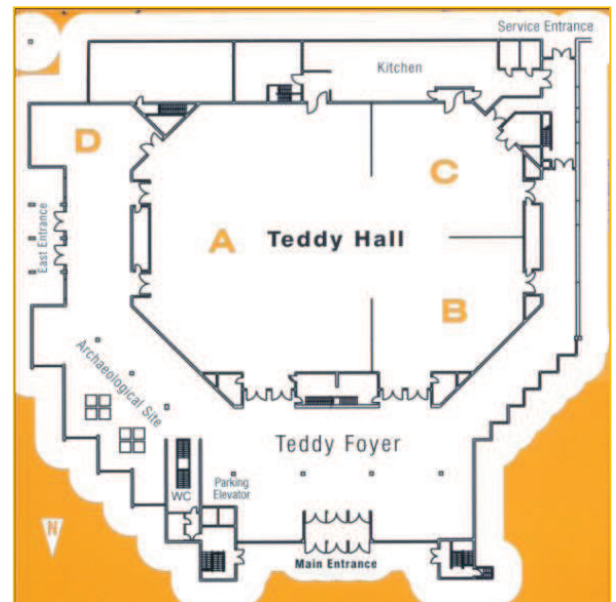

The Schwartz Auditorium (1st Floor Diagram)

The Schwartz Auditorium is located near the Convention Centre's Entrance Hall, across from the Coffee Shop. It is used for hosting lectures and panel discussions, shows, movies, multimedia productions, plays, ceremonies, conventions, and press conferences. At the Auditorium's front there is the stage with a presentation screen. The Auditorium contains 390 permanent seats, positioned on two levels. Access to the balcony is via the rounded stairs. The hall is suitable for **Technical Sessions**.

Schwartz Auditorium Maximum Occupancy: 390 people

(Hall – 289 seats, Balcony – 101 seats)

Stage dimensions are: Depth: 7.45m, Width: 11m.

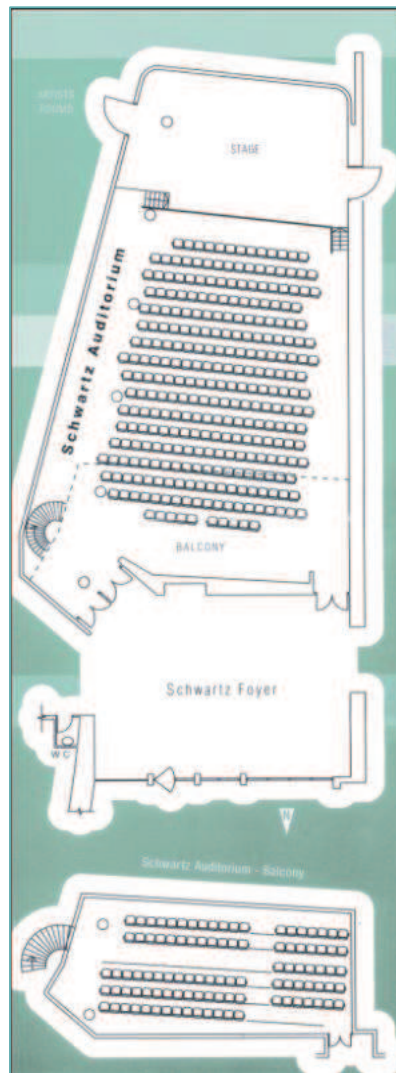

Oranim Halls (1,2,3,4 in 1st Floor Diagram)

Flexibility in structure and functionality

The Oranim wing is considered one of the most elegant and attractive sites for conferences. The wing composed of four halls, which can be joined into a big hall or used individually. Its modular structure allows it to function as a large conference hall with 790 seats, or as a wide scale complex for exhibitions, especially the kind containing large display stands and exhibits. Acoustic wooden partitions divide the four halls and impart a warm atmosphere. Wall hangings, low ceilings and dimmer lighting amplify the pleasant and intimate atmosphere of this wing. The halls are suitable for **Technical Sessions**.

- Oren 1 Hall:** 160 square meters
Maximum Occupancy: 130 people
- Oren 2 Hall:** 160 square meters
Maximum Occupancy: 160 people
- Oren 3 Hall:** 215 square meters
Maximum Occupancy: 230 people
- Oren 4 Hall:** 215 square meters
Maximum Occupancy: 230 people

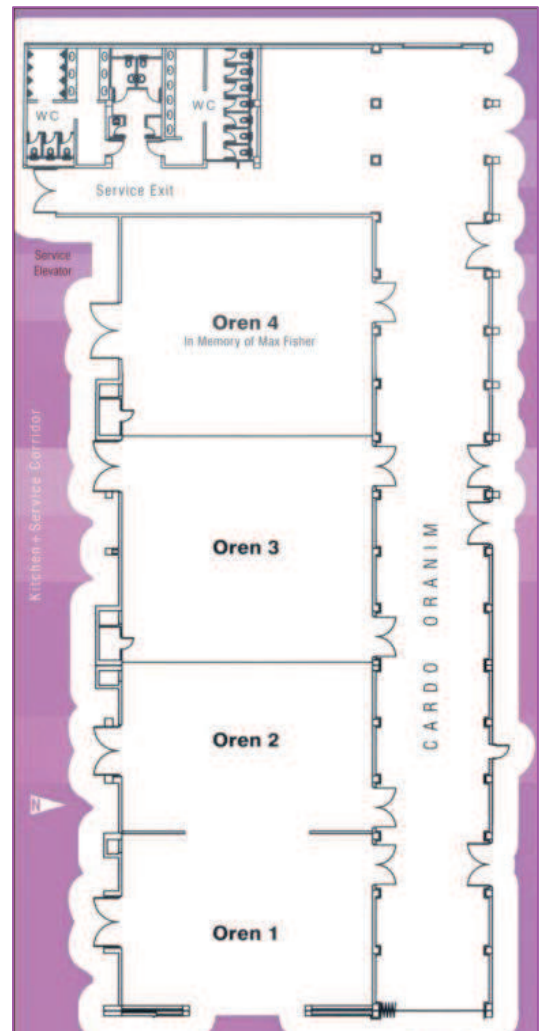

The Eshkol Auditoriums (1st Floor Diagram)

The Eshkol Auditorium complex is comprised of 3 Halls that differ in size and shape. All the Halls contain permanently fixed seats, a stage, an exhibition screen and adjoining screening room. The halls are suitable for **Technical Sessions**.

Eshkol Auditorium 1: Stage Width: 6.15m Depth: 2.65m
Maximum Occupancy: 119 people

Eshkol Auditorium 2: Stage Width: 9m Depth: 3.2m
Maximum Occupancy: 225 people

Eshkol Auditorium 3: Stage Width: 8.2m Depth: 3.2m
Maximum Occupancy: 127 people

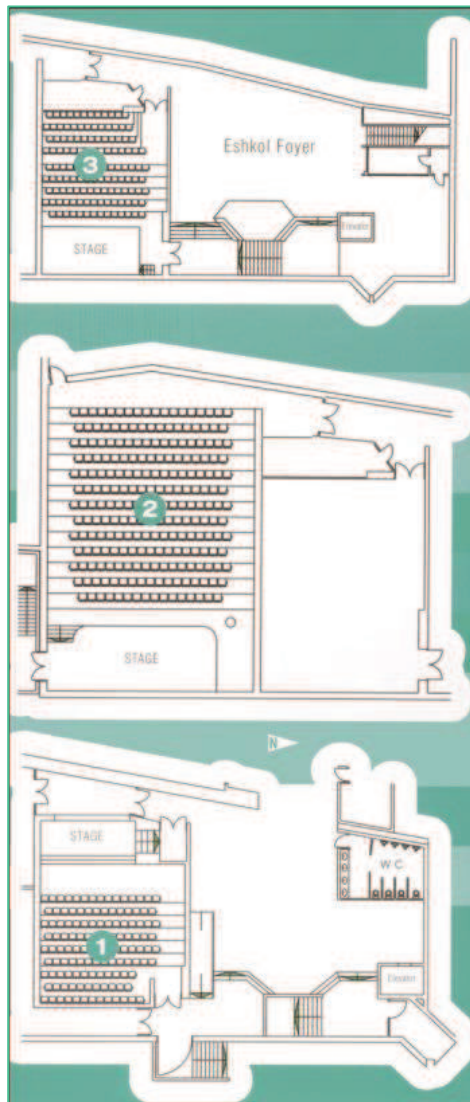

The Glass Hall (1st Floor Diagram) – Registration

The Glass hall is the main entrance to the convention centre.

The space is vast and ideal for **Registration**, Optional for additional exhibition area.

Glass Foyer Size: 343 Square Meters

Maximum Occupancy: 200 people

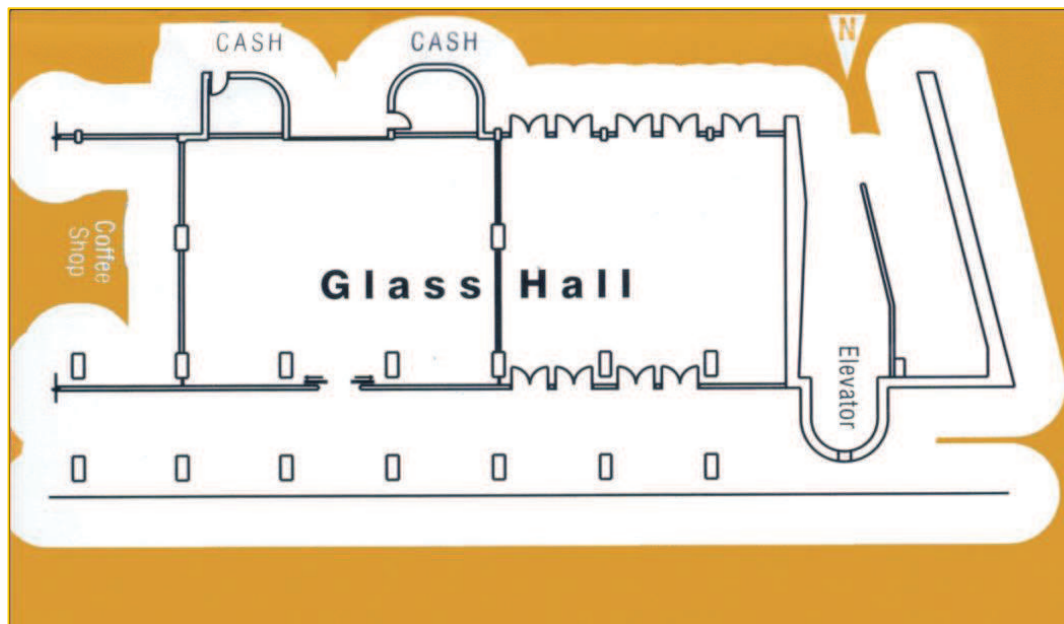

Exhibition & Posters Boards Area

The exhibition area will be located at the Entrance Lobby, Pincus Hall, Exhibition Hall and Agam Foyer (total of 3,200 sqm). Should there be need for additional exhibition space, it is possible to construct a tent of 1,000 sqm at the entrance to the ICC Glass Hall.

The entire exhibition area will be divided for **Food Courts, Internet Café, IAC Exhibition, Students Exhibition, Poster Boards and Accompanying Persons' area.**

Entrance Lobby (1st Floor Diagram)

The elegant and spacious entrance lobby is the central meeting point of the Convention Center. This hall is particularly suitable for exhibitions, cocktail parties, coffee breaks and rest periods.

Entrance Lobby Size: 550 Square Meters

Maximum Occupancy: 800 people

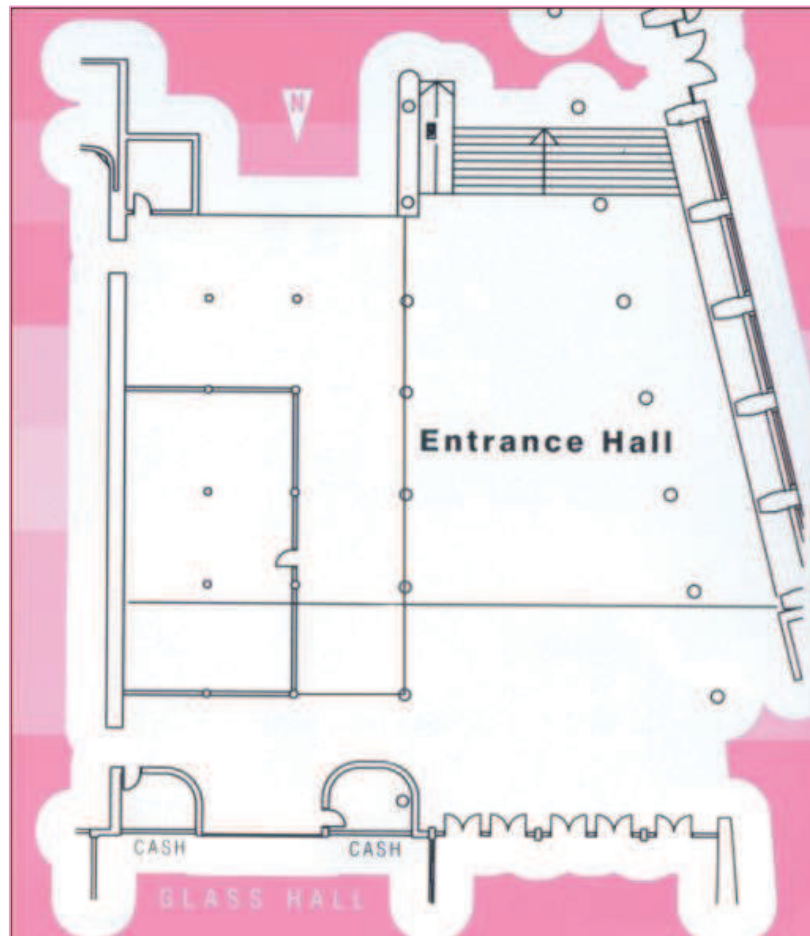

Pincus Hall (1st Floor Diagram)

Along with the Entrance Hall and Lounge, Pincus Hall creates a concurrent and open territory, especially good for exhibitions. The hall will be modified into an open space without walls.

Pincus Hall Size: 427 Square Meters

Maximum Occupancy: 600 people



Agam Foyer (2nd Floor Diagram)

Situated up the stairs from Pincus Hall, Agam Foyer is the ideal location for hosting additional **Exhibition, Posters and Accompanying Person Area**. The Foyer is used as an entrance to the Ossishkin Auditorium. Its large windows, standing from the ceiling to the floor all across the Hall, provide the most amazing view of Jerusalem in the daylight, and at night time -the spectacular lights of the city.

Agam Foyer Size: 1,140 Square Meters

Maximum Occupancy: 1,300 people

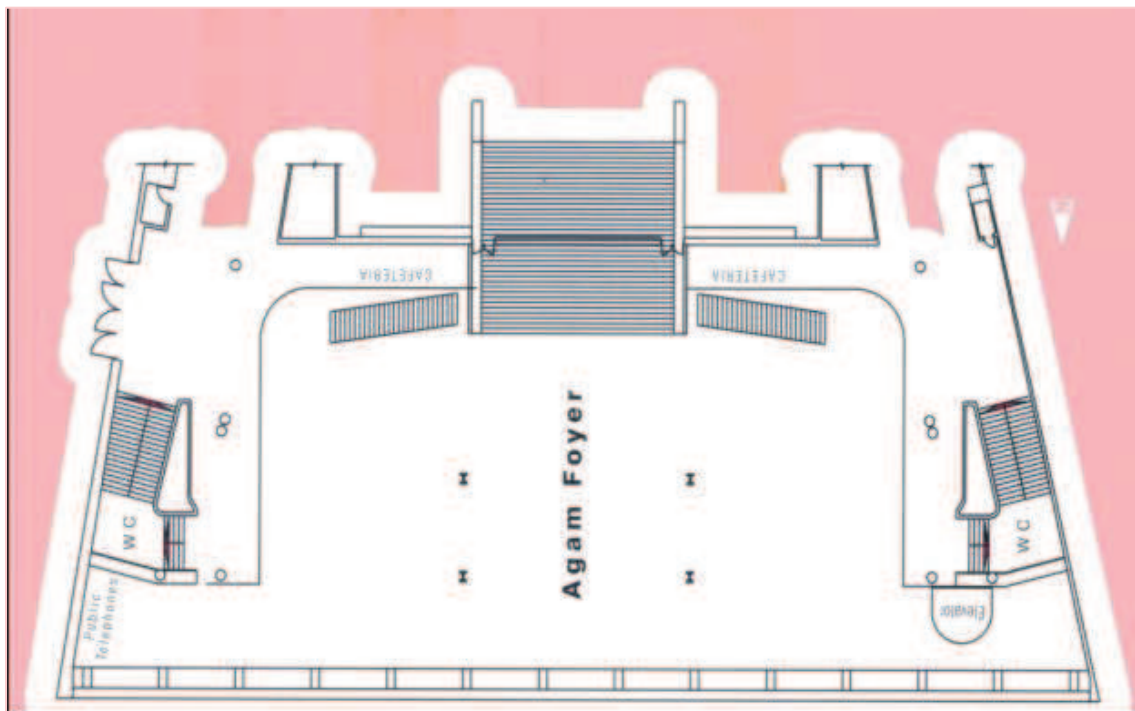

Exhibition Hall (1st Floor Diagram)

Perfectly suitable for **Exhibitions, Posters, Internet Cafe**, and diverse assemblies. Its vast space is ideal for exhibitions that stand alone, or, are part of a convention. In the rectangular Hall, one can cater full service or a buffet, per choice or requirements. There is also the option to enter the Hall from the separate entrance at the northern front of the Convention Centre.

Exhibition Hall Size: 1,085 Square Meters

Maximum Occupancy: 1,400 people

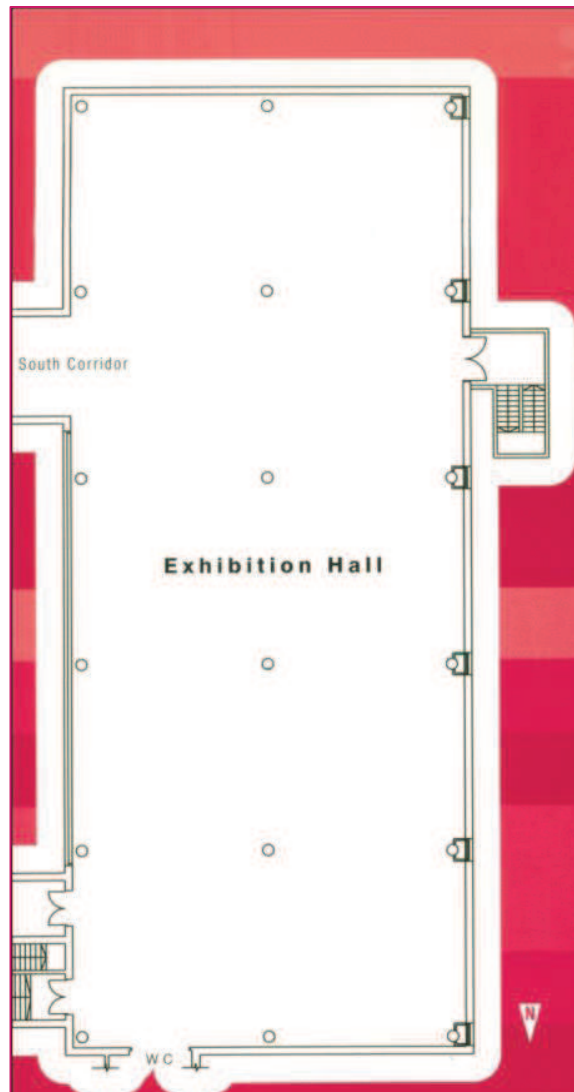

ICC Exhibition Space

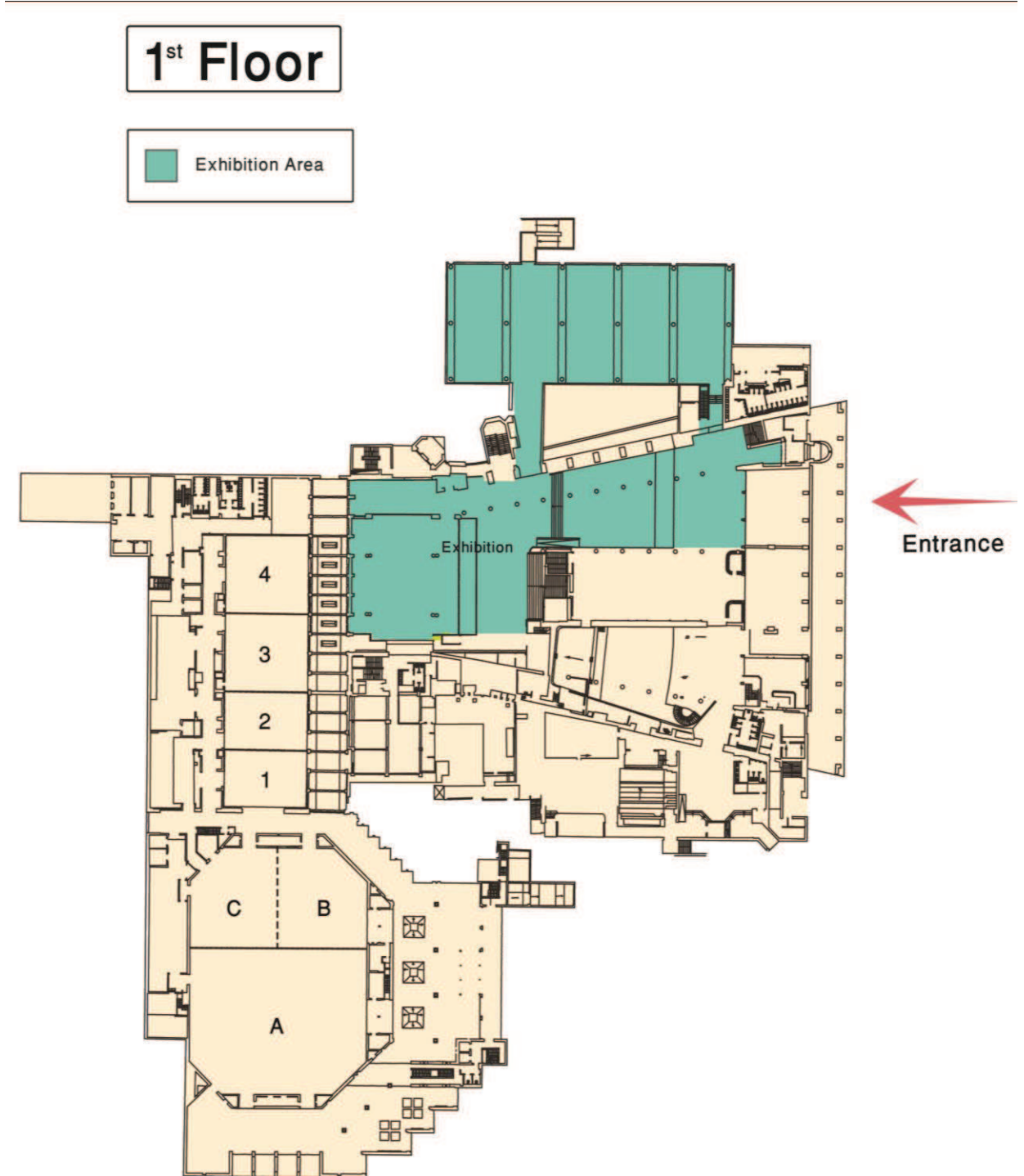

2nd Floor

Exhibition Area

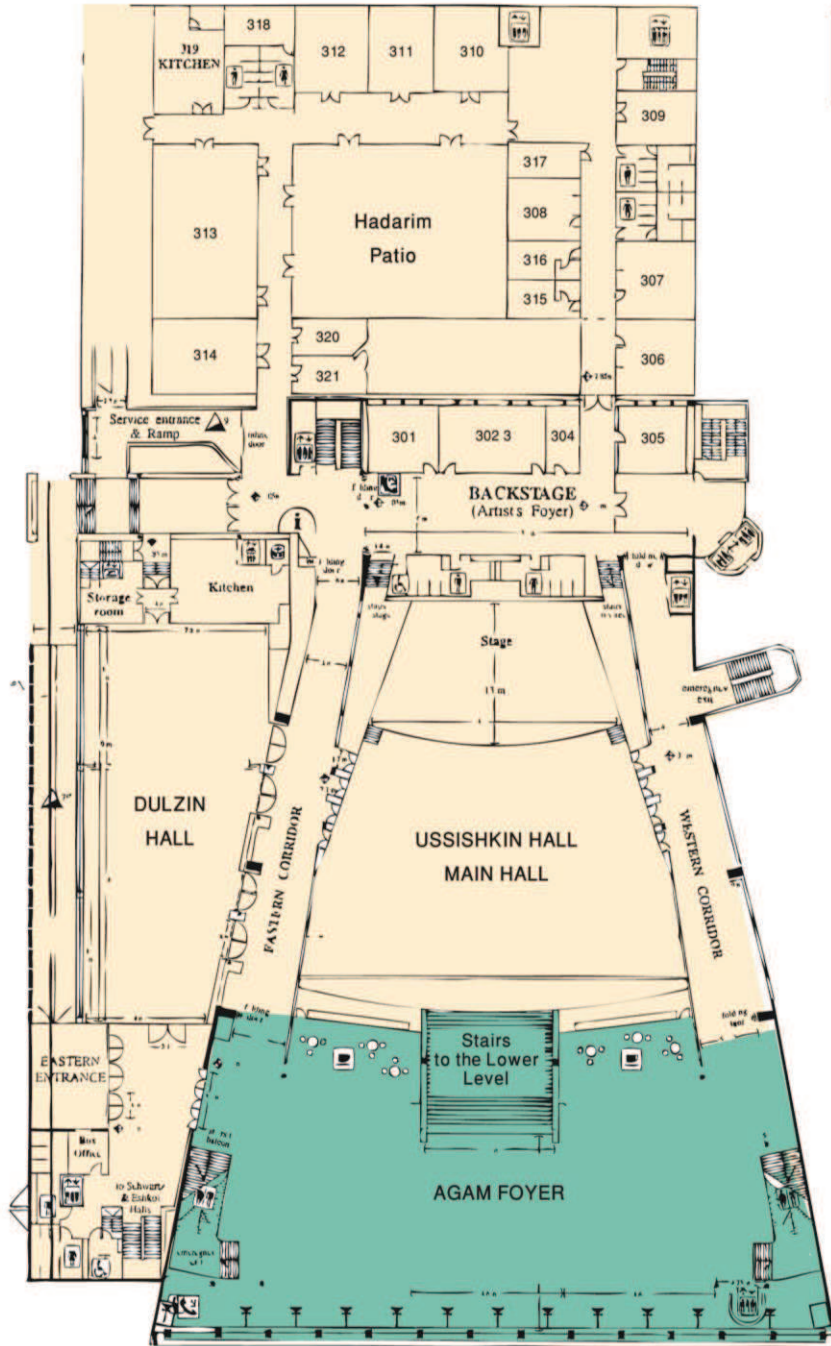

The Ussishkin Auditorium (2nd Floor Diagram)

With its spaciousness, first rate acoustics, state-of-the-art equipment and the finest support services available, the Ussishkin auditorium provides the perfect solution for hosting large scale conventions. The auditorium is suitable to host **The Opening Ceremony, Welcome Reception, Plenary and Highlight Lecture Sessions.**

Ussishkin Auditorium Maximum Occupancy: 3,000 people
Stage Depth: 13 Meters, Stage width: 23 Meters, Height: 11 Meters.

Special equipment and facilities: 30 monitors (20 electric), one stage, three-phase electric power outlets, three translation cubicles, recording and broadcasting studios for radio, TV stations for live broadcasting.

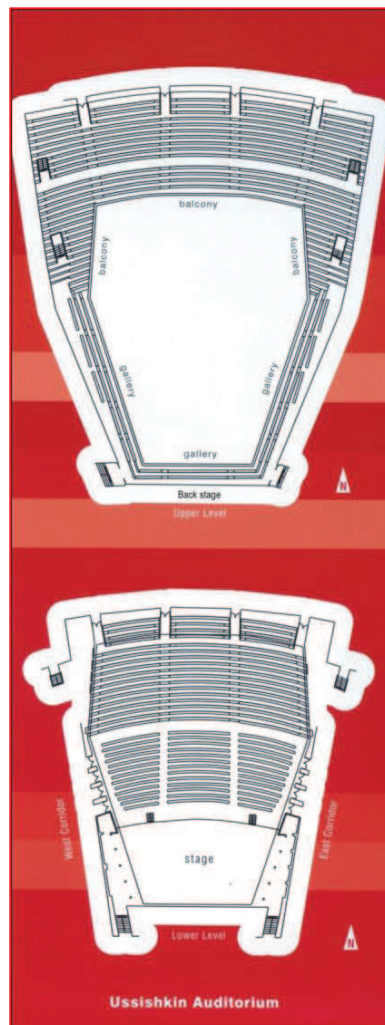

Dulzin Hall (2nd Floor Diagram)

Dulzin Hall is located next to the auditorium and Agam Lounge. An acoustic barrier enables the division of the hall into two separate spaces that differ in size and capacity, so that it may be modified to the nature and size of the event. The uniqueness of Dulzin Hall is evident and reflected in the large glass windows that enable its visitors to enjoy an aired, lit hall that overlooks an amazing view of Jerusalem. Rolling curtains enable to darken the room, if necessary.

Dulzing Big Hall is suitable for **Special Purpose Room Workshops**.

Dulzing Small Hall is suitable for **Technical Sessions**.

Dulzing Big Hall Size: 365 Square Meters
Maximum Occupancy: 500 people

Dulzing Small Hall Size: 250 Square Meters
Maximum Occupancy: 250 people

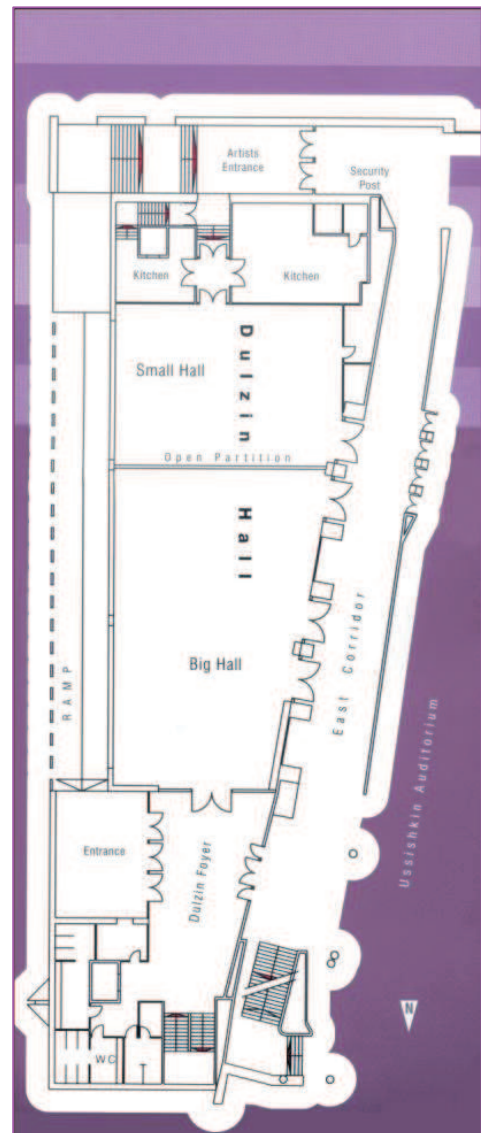

Hadarim Patio (2nd Floor Diagram)

The Hadarim Courtyard gives a unique magical atmosphere. The naturally lit extensive courtyard is surrounded by glass walls and has a beamed ceiling. It can be used throughout the entire year and is designed to host receptions, dinners, conventions, art exhibitions and coffee breaks during conventions and conferences.

The courtyard is encompassed by variety of seminar rooms of varying shapes and sizes. It offers the participants of the seminar the ideal place to relax. The nearby kitchen is well equipped and provides the courtyard with a range of catering options, from a cup of coffee to a three course meal. Hadarim Patio is the suitable hall for **VIP Private Dining Area Luncheon** alongside **Press Center** in Hadarim Patio 3.

Hadarim Patio Size: 323 Square Meters

Maximum Occupancy: 300 people

Seminar Rooms (2nd Floor Diagram)

The Seminar Rooms (301 – 314) of the Convention Centre-ICC are designed for seminars, lectures and a variety of small events. The rooms are suitable for **Technical Sessions, Committee Meeting Rooms, IAF President Office, IISL President Office, IAA President Office, IAF Executive Director Office, IPC Co-Chairs Office, IAF Secretariat Office, IAA Secretariat Office and Speaker Preparation Room.**

The rooms are equipped with moveable chairs, integrated presentation boards, portable flip boards, audio-visual equipment and international telephone lines.

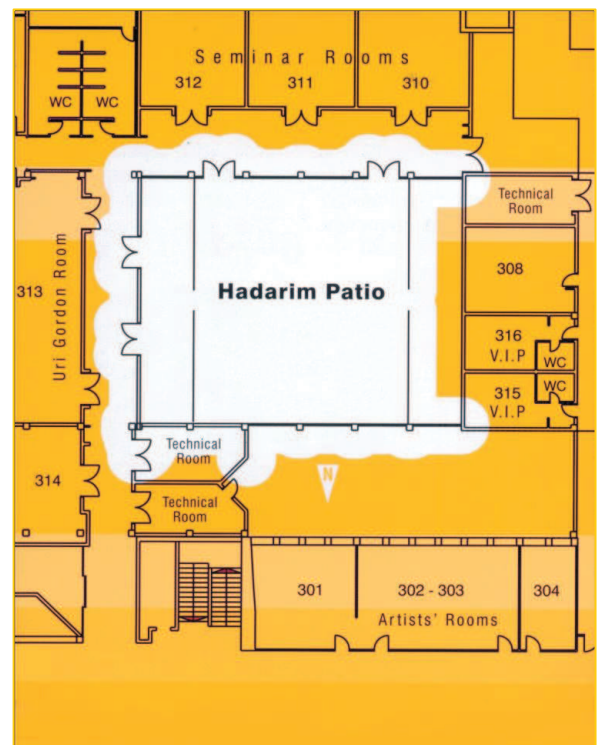

ICC Plenary, Parallel Halls & Exhibition

Agam Foyer



Teddy Hall



Exhibition Hall



Entrance Hall



Hadarim Patio



Ussishkin Auditorium

The Crowne Plaza Hotel - Congress Centre

Just 3-5 minutes walking distance from ICC Convention Centre



The Crowne Plaza Hotel is one of the most luxurious and well-known Jerusalem hotels. From its location, at the highest point in the city, the Hotel offers breathtaking views of the beautiful city of Jerusalem. **The Hotel is next door to the International Convention Centre-ICC**, and within walking distance from the Israel Museum, the Knesset, the Supreme Court and more.

The convention complex, which covers an entire floor of the Crowne Plaza Jerusalem Hotel, specializes in high-class conventions, and has hosted leading international and local conventions, seminars and many other events. The complex, which has a classic, contemporary design, includes: 10 new exclusive and Halls in various sizes, for events up to 1000 guests.

Every Hall is fitted with a sound system, gigantic screens, a smart lighting system and technical equipment, which allows preparing videos, conference call and more. Reception in the Foyer or in the Hotel's garden, are extraordinary as the garden is spacious, with manicured lawns.

Crowne Plaza Meeting Halls

The halls are suitable for **Technical Sessions** and **Committee Meeting** Rooms. In addition, Crowne Plaza provides spare room for meetings and Dining room for VIP's Luncheon.

Ein Gedi Hall Size: 110 Square Meters
Maximum Occupancy: 50 people

Arad Hall Size: 55 Square Meters
Maximum Occupancy: 50 people

Jericho Hall Size: 55 Square Meters
Maximum Occupancy: 50 people

Massada Hall Size: 55 Square Meters
Maximum Occupancy: 50 people

Grand Ballroom A Size: 321 Square Meters
Maximum Occupancy: 300 people

Grand Ballroom B Size: 321 Square Meters
Maximum Occupancy: 350 people

Kerem and Carmit Hall Size: 220 Square Meters
Maximum Occupancy: 150 people



Ein Gedi Hall



Grand Ballroom A



Kerem and Carmit Hall



Grand Ballroom B



Meeting Room – Spare Room